

English

Pairing

When the remote control cannot control the lamp, or if you want a remote control to control two or more lamps: When the lamp is on, press and hold the on/off button of the remote control. At the same time, use the power switch to quickly turn the lamp off and on 4 times within 5 seconds. The lamp will flash, indicating that the pairing is successful.

中文

遥控器配对

当遥控器无法操控灯具时，或者想用—个遥控器控制两盏或以上灯具时：在亮灯情况下，持续长按遥控器开关键，同时将要配对的灯具在5秒内关/开4次，灯具闪烁表明配对成功。

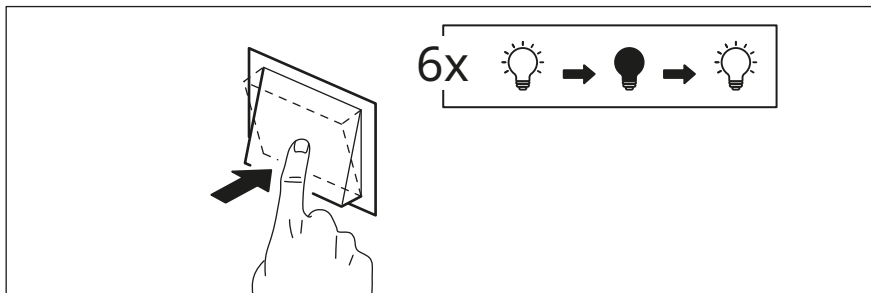

English

Unpairing

When need remove the connection between lamp and remote control, keep the lamp on, use the power switch to quickly turn the lamp off and on 6 times within 10 seconds.

The lamp will flash, indicating that unpairing is successful.

中文

遥控器解除配对

当需要把遥控器跟灯具解除配对时，将需解除配对的灯具在10秒内ON/OFF 6次，灯具闪烁表示解除配对成功。