

FROSTDIMMA

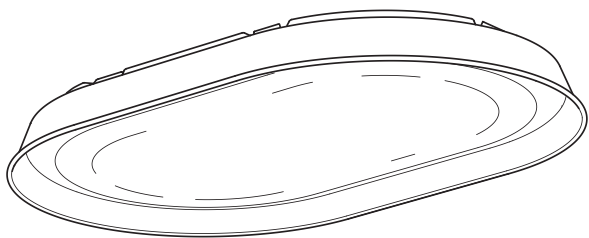

Design and Quality
IKEA of Sweden



English

IMPORTANT

If you have any problems regarding the electrical installation, contact an electrician.

Always shut off power to the circuit before starting installation work.

SAVE THESE INSTRUCTIONS FOR FUTURE USE

English

The light source of this luminaire is not replaceable; when the light source reaches its end of life the whole luminaire shall be replaced.

中文

重要信息

如果您对电力安装有任何疑问，请联系电工。安装工作开始前，请始终关闭电路的电源。

保留这些说明，以便日后所需。

中文

该照明装置内的光源不可替换，若光源无法继续使用，必须更换整个照明装置。

繁中

重要資訊

如果你有與電氣安裝相關的問題，請與專業人員聯絡。開始安裝前，務必關掉電路電源。

請保留說明書，以供未來參考。

繁中

不可更換燈泡；如果燈泡無法發亮，請更換整組燈具。

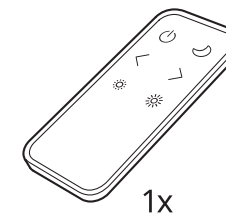
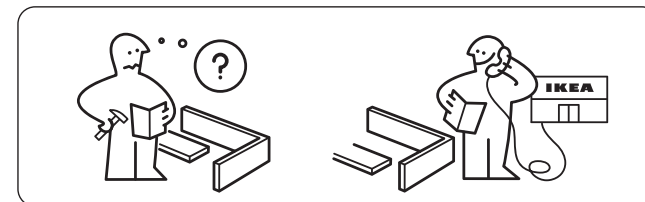
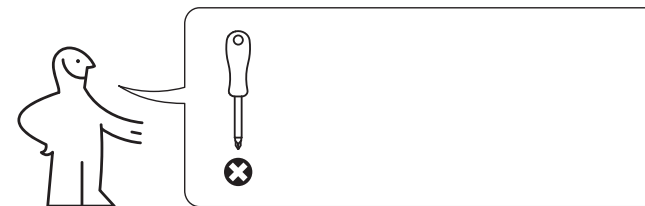

1

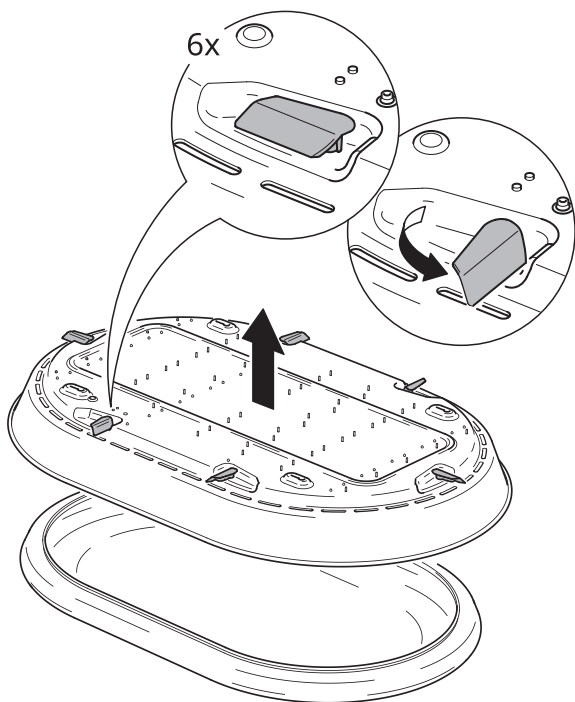

2

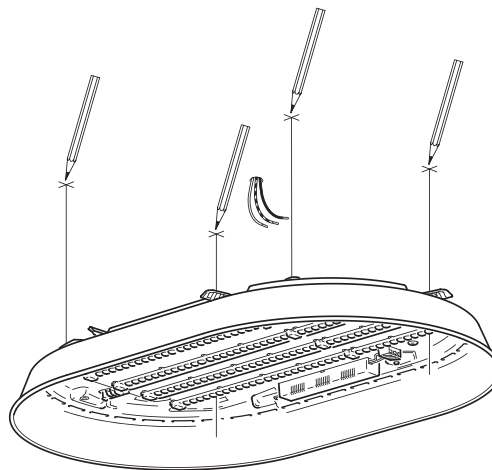

3

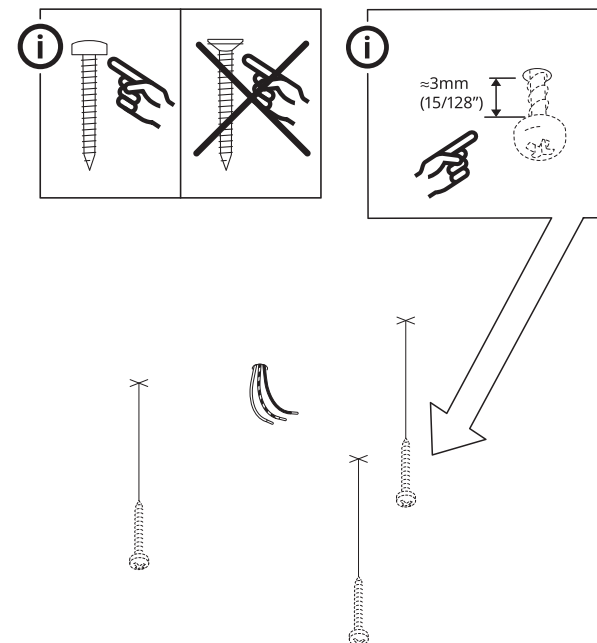

4

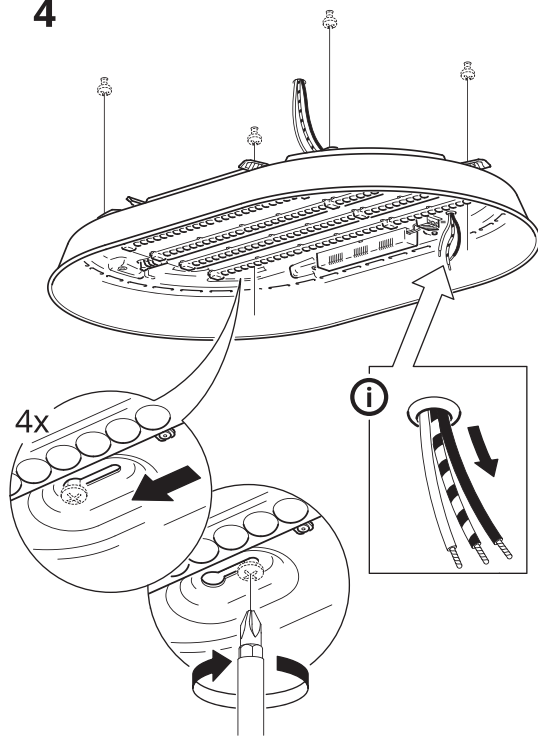

5

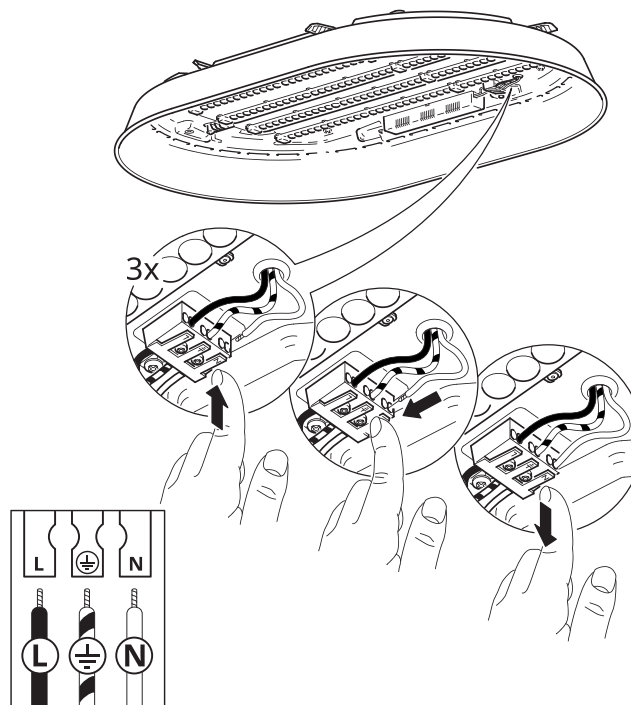

6

