

SKOTAT

1.8m

5' 11"

2xUSB-C

PD (1x45W / 2x22W)

250V ~ 10A 2500W



AA-2679900-1

Made in China

© Inter IKEA Systems B.V. 2025



IKEA of Sweden AB
SE-343 81 Älmhult

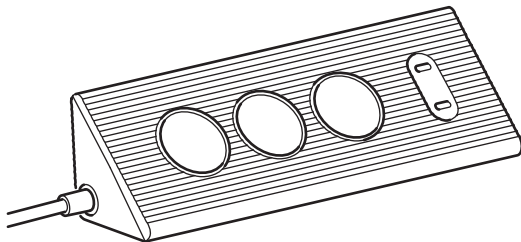

1R15-IDG DM



Design and Quality
IKEA of Sweden

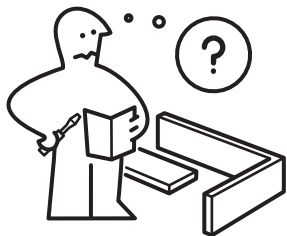

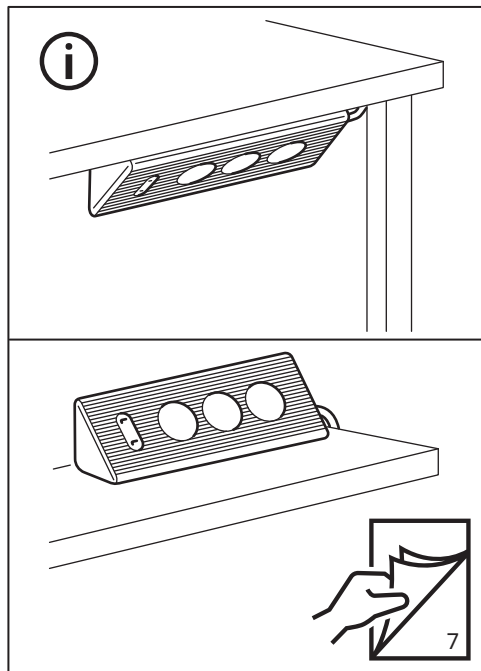
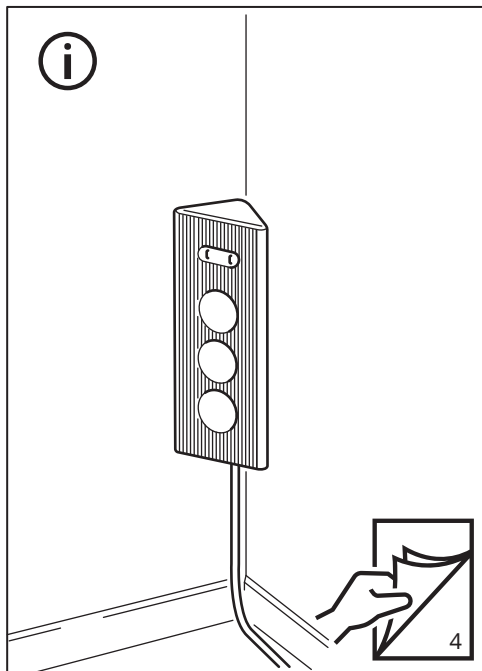

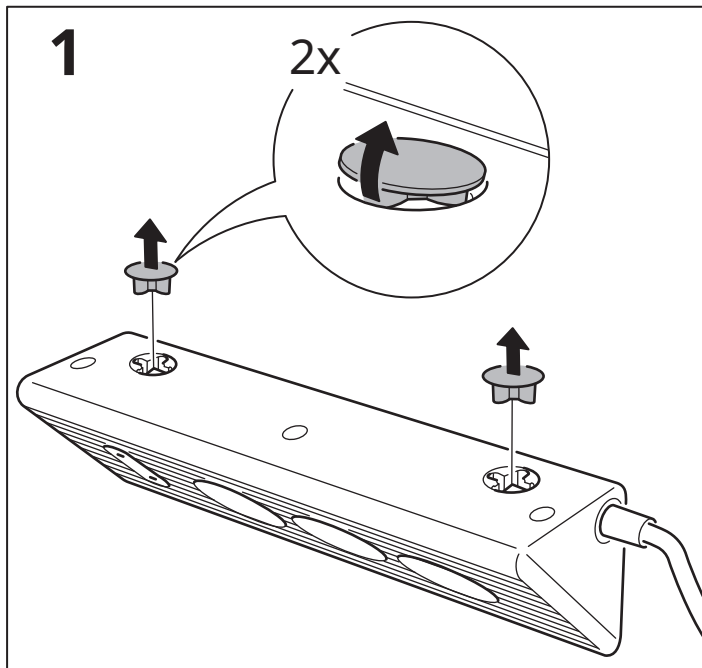
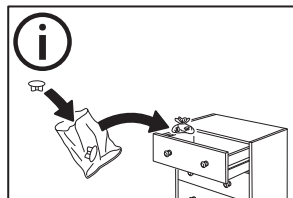
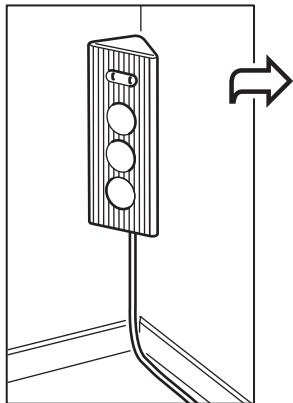

2

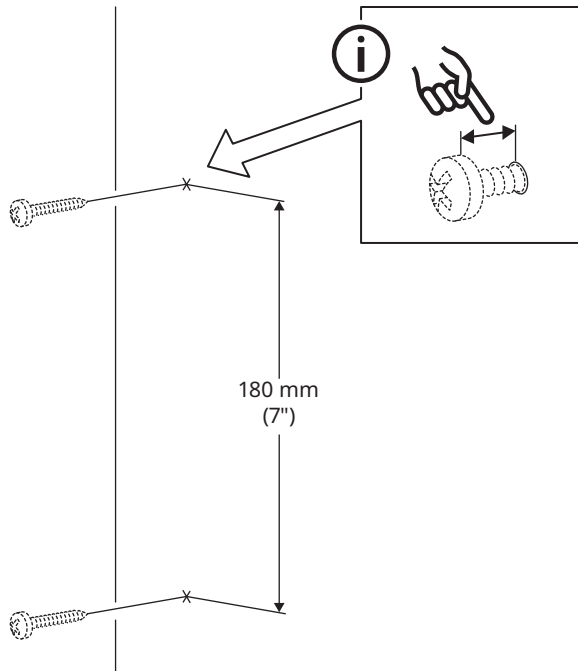
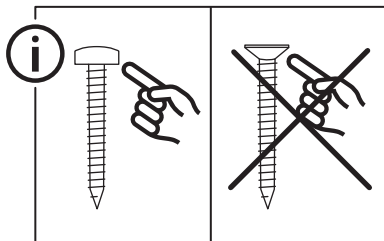

3

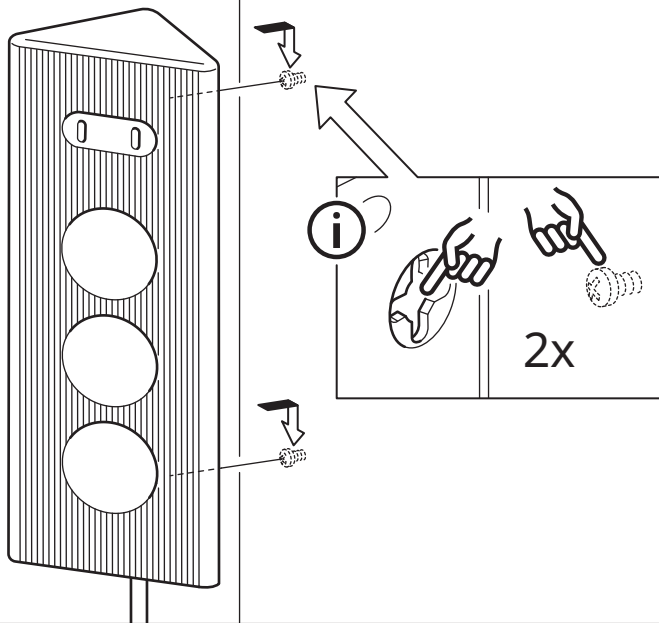

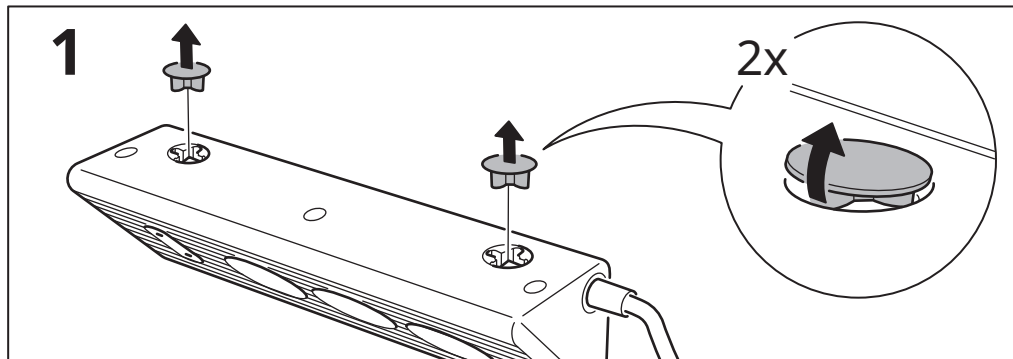
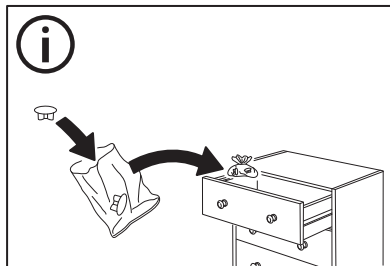
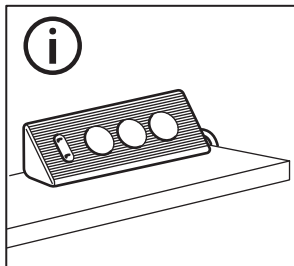
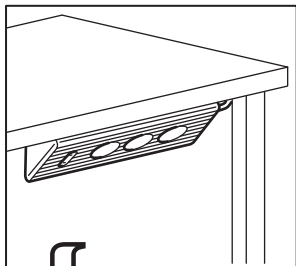

2

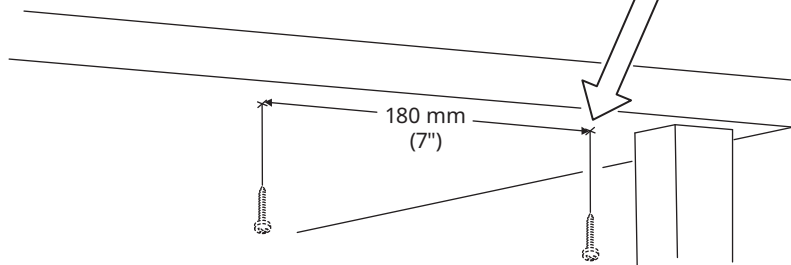
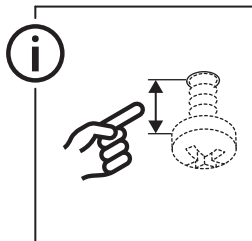
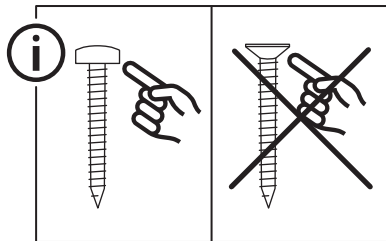

3

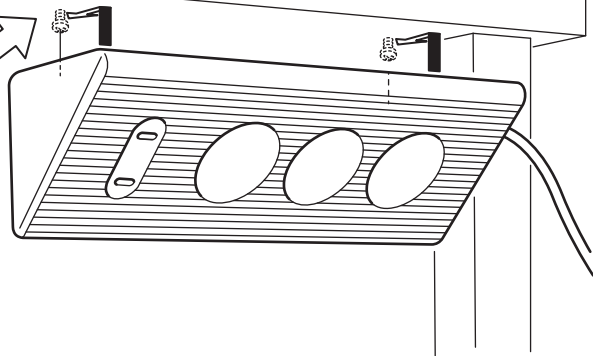
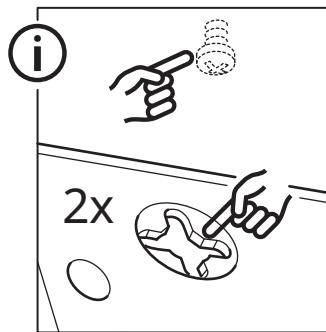

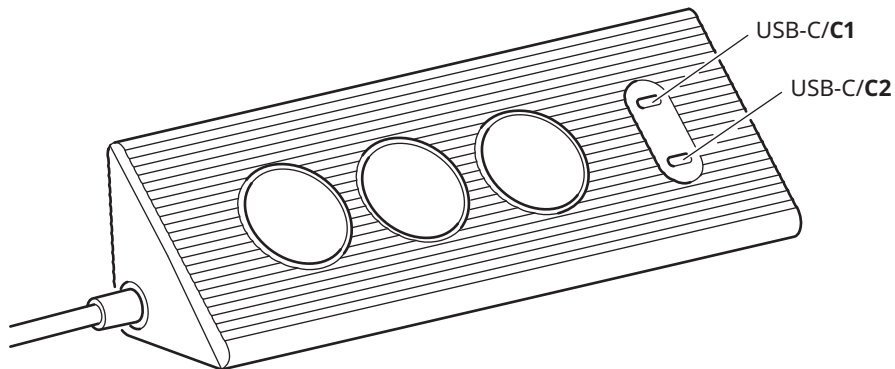

PD
3.0

QC
4+

PPS

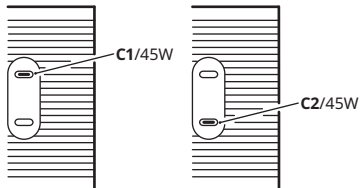

C1/C2:

5.0V \equiv 3.0A 15.0W
 9.0V \equiv 3.0A 27.0W
 12.0V \equiv 3.0A 36.0W
 15.0V \equiv 3.0A 45.0W
 20.0V \equiv 2.25A 45.0W
 PPS: 5.0-16.0V \equiv 3.0A 45.0W

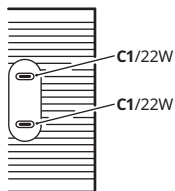

C1:

5.0V \equiv 3.0A 15.0W
 9.0V \equiv 2.44A 22.0W
 12.0V \equiv 1.83A 22.0W
 15.0V \equiv 1.46A 22.0W
 20.0V \equiv 1.10A 22.0W
 PPS: 5.0-11.0V \equiv 2.4A 22.0W

C2:

5.0V \equiv 3.0A 15.0W
 9.0V \equiv 2.44A 22.0W
 12.0V \equiv 1.83A 22.0W
 15.0V \equiv 1.46A 22.0W
 20.0V \equiv 1.10A 22.0W
 PPS: 5.0-11.0V \equiv 2.4A 22.0W

中文

13

English

14

中文



请仔细阅读此说明手册，并妥善保管，以便日后参考。

重要须知！

- 请务必按顺序依次连接。
- 使用时请勿遮盖产品。
- 仅能使用适用于IT设备的USB接口。
- 断开电源时，请拔下插头。
- 仅可在室内干燥区域使用。

警告

- 产品损坏后请丢弃。
- 由于温度负载升高，因此只有当线缆展开时才能使用。
- 切勿使用损坏或有故障的USB电线充电，否则会损坏充电器和你的设备。
- 切勿将充电器浸入水中或其他液体中。
- 请勿超负荷使用本产品。
- 使用不当可能会损坏产品，或造成人员伤亡或财产损失。
- 请勿让儿童玩耍设备。
- 仅适用于海拔2000m及以下地区安全使用。
- 仅适用于非热带气候条件下安全使用。
- 禁止普通延长线插座用于电动自行车充电。
- 在多个插头同时插入使用时，其负载的总功率不得超过最大允许功率。
- 请不要盘绕使用延长线插座，若盘绕使用，则实际可承载的电流值会低于其额定值。



USB-C接口功能

- 最多可同时为两台设备充电。
- 每个USB-C接口的输出功率：
 - 一个USB-C接口工作时：45.0瓦
 - 两个USB-C接口工作时：22.0瓦
- USB-C充电器可兼容Power Power Delivery (PD 3.0)、Quick Charge (QC4+)和Programmable Power Supply (PPS)。
- USB-C充电器支持手机和平板电脑快速充电。此充电器还可以用于大多数笔记本电脑的充电。充电速度取决于所连接的设备。
- 内置安全功能，可防止USB-C接口出现短路、过热和过载。

USB-C接口使用说明

将产品连接到墙上插座。将USB-C电线的一端插入空闲的USB-C接口，另一端插入需要充电或供电的设备。

注意！ 不含USB-C电线。

保养说明

清洁产品时，请拔下电源插头，并用干布擦拭。

产品须知

- USB电线的长度和质量会影响充电速度和性能。
- 设备在充电过程中可能会发热。这是正常现象；充满电后设备会逐渐冷却。
- 工作温度：0° C至40° C (32° F至104° F)。
- 不使用时，请从电源上拔下加长电线。
- 建议使用年限：15年

制造商：宜家瑞典有限公司(IKEA of Sweden AB)

地址：Box 702, SE-343 81 Älmhult, SWEDEN

技术数据

类型: SKOTAT 斯库塔

型号: E2308-CN

输入: MAX 10A 250V ~ MAX 2500W

输出功率: MAX 10A 250V ~ MAX 2500W

输入: 220-240V ~50/60Hz 0.6A

USB-C输出功率:

单个USB-C接口工作时: 最大45.0瓦 C1或C2	两个USB-C接口工作时: 最大 22.0瓦/端口 C1和C2
5.0V \rightleftharpoons 3.0A 15.0W, 9.0V \rightleftharpoons 3.0A 27.0W, 12.0V \rightleftharpoons 3.0A 36.0W, 15.0V \rightleftharpoons 3.0A 45.0W, 20.0V \rightleftharpoons 2.25A 45.0W, PPS: 5.0-16.0V \rightleftharpoons 3.0A 45.0W	5.0V \rightleftharpoons 3.0A 15.0W, 9.0V \rightleftharpoons 2.44A 22.0W, 12.0V \rightleftharpoons 1.83A 22.0W, 15.0V \rightleftharpoons 1.46A 22.0W, 20.0V \rightleftharpoons 1.10A 22.0W, PPS: 5.0-11.0V \rightleftharpoons 2.4A 22.0W

执行标准: GB 1002-2024; GB 2099.7-2024; GB 17625.1-2022
(A类);GB 4943.1-2022; GB/T 9254.1-2021



带十字的垃圾桶标志代表该产品必须与家用垃圾分开处理。同时对产品的处理必须符合当地关于废物处理的相关规定。每做一次分类,就减少了送入焚烧炉和垃圾填埋场垃圾的数量,进而将不利于人类身体健康和环境的负面影响最小化。想了解更多,请联系当地宜家商场。

English



Read instructions carefully and keep for future reference.

IMPORTANT!

- Do not connect after each other in a sequence.
- Do not cover the product when in use.
- Only use the USB outlet for IT devices.
- To disconnect the power, pull the plug.
- Use only indoors in dry areas.

WARNING

- Discard the product if damaged.
- Only operate when uncoiled due to increased temperature load.
- Never use a damaged or faulty USB cable, since this can damage or harm the charger or your device.
- Never submerge the charger in water or other liquids.
- Do not overload the product.
- Improper use may cause damage to the product or endanger people or property.
- Children should be supervised to ensure they do not play with the product.
- Only suitable for safe use at altitudes of 2000m and below.
- For safe use in non-tropical climates only.
- Ordinary extension cord sockets are prohibited from being used for charging electric bicycles.
- When multiple plugs are plugged in simultaneously, the total power load must not exceed the maximum permissible power.
- Do not coil the extension cord; if coiled, the actual current it can handle will be lower than its rated value.

USB-C outlet features

- Charges up to 2 devices simultaneously.
- Output power per USB-C outlet:
 - one USB-C outlet in use: 45.0W
 - two USB-C outlets in use: 22.0W
- The USB-C charger is compatible with Power Delivery (PD 3.0), Quick Charge (QC4+) and Programmable Power Supply (PPS).
- The USB-C charger supports quick charging of phones and tablets. The charger can also support charging of most laptops. The charging speed is determined by the connected device.
- Built-in safety features protect the USB-C charger from short-circuiting, overheating and overloading.

Instructions for use for USB-C outlets

Connect the product to the wall socket. Insert USB-C cable end into free USB-C outlet and the other end to the device you want to charge or power.

NOTE! USB-C cable is not included.

Care instructions

To clean the product, unplug from power source and wipe with a dry cloth.

Good to know

- USB cable length and quality influences charging speed and performance.
- Devices may get warm during charging. This is completely normal, and they will gradually cool down again after they are fully charged.
- Operating temperatures: 0° C to 40° C (32° F to 104° F).
- Unplug the extension cord from the power source when not in use.
- Recommended service life: 15 years

Manufacturer: IKEA of Sweden AB

Address: Box 702, SE-343 81 Älmhult, SWEDEN

Technical data

Model: E2308-CN

Type: SKOTAT

Input: MAX 10A 250V ~ MAX 2500W

Output: MAX 10A 250V ~ MAX 2500W

USB-C output:

One USB-C outlet in use: Max 45.0W C1 or C2	Two USB-C outlets in use: Max 22.0W per port C1 and C2
5.0V \equiv 3.0A 15.0W, 9.0V \equiv 3.0A 27.0W, 12.0V \equiv 3.0A 36.0W, 15.0V \equiv 3.0A 45.0W, 20.0V \equiv 2.25A 45.0W, PPS: 5.0-16.0V \equiv 3.0A 45.0W	5.0V \equiv 3.0A 15.0W, 9.0V \equiv 2.44A 22.0W, 12.0V \equiv 1.83A 22.0W, 15.0V \equiv 1.46A 22.0W, 20.0V \equiv 1.10A 22.0W, PPS: 5.0-11.0V \equiv 2.4A 22.0W

Executive standard: GB 1002-2024; GB 2099.7-2024;
GB 17625.1-2022 (class A); GB 4943.1-2022;
GB/T 9254.1-2021



The crossed-out wheeled bin symbol indicates that the item should be disposed of separately from household waste. The item should be handed in for recycling in accordance with local environmental regulations for waste disposal. By separating a marked item from household waste, you will help reduce the volume of waste sent to incinerators or land-fill and minimize any potential negative impact on human health and the environment. For more information, please contact your IKEA store.

